

# Snow Removal and De-Icing

## SNOW REMOVAL

The City of Orem has two public works sections that are assigned to clear all city owned streets in Orem. Trained employees from the streets section and storm water section are responsible for this important task. The city has outlined how this operation is performed in detail in a publicly accessible document called [Snow and Ice Control Plan](#) which is posted on our webpage at [orem.org/streets/](http://orem.org/streets/).



As residents in Orem, you play a part in our city's snow removal efforts. Many of you work hard to clear your driveways for your own benefit and clear your sidewalks for everyone's benefit. Thank you!

As a reminder to those who do not keep a habit of clearing snow from your property, Orem code states:

### **"16.1.6. Clearing Sidewalks.**

A. **Generally.** The owners, occupants, tenants, and lessees of all real property shall keep the public sidewalks, curbs, and gutters abutting the property free from debris, dirt, rocks, weeds, snow, and ice."

When it comes to clearing driveways, many residents could get frustrated when they push the snow into the street at the end of the driveway just to have a city operated plow push it right back towards their property. To prevent this frustration, we suggest shoveling all of the snow from your driveway onto the sides of your driveway. In other words, work side to side across your driveway and throw the snow onto landscaping. This method recharges ground water, vegetation filters pollutants in the snow melt, and prevents potential frustrations.

Alternatively, following the diagram to the right would also likely prevent snow from reentering your driveway area.

## ***How to Prevent the "Second Shovel"!***

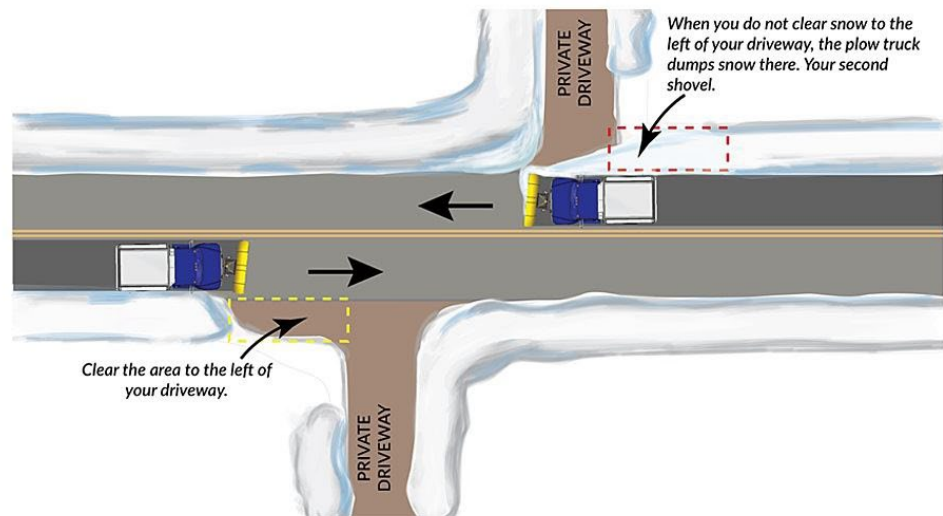

<https://www.villageofombar.org/336/Snow-Plowing>

## DE-ICING

The city uses mined road salt to aid in melting snow and ice as well as providing traction for vehicles. This salt

is used minimally in order to lower the negative impacts on the environment. We suggest that as residents use de-icers on their property, to also be discretionary to prevent any damage to your landscaping or impacting storm water quality negatively. Thank you for helping to build a better Orem!